



EcoPro / EcoEvo / EcoAdd

The innovative metering pump generation

- ▲ Clear operating structure
- ▲ Variable arrangement of control unit and mounting console
- ▲ Different metering modes adjustable (e.g. for high-viscosity products)
- ▲ Electronic metering rate setting up to 1:12000
- ▲ Multi-color touch display (EcoAdd)
- ▲ USB interface (EcoAdd)

Diaphragm metering pumps with powerful stepper motor drives of the EcoPro, EcoEvo and EcoAdd series offer innovative metering technology that combines maximum precision, high efficiency and advanced technology. Thanks to their modular design, these devices can be flexibly adapted to different processes.

EcoAdd



EcoPro



EcoEvo



Technical Data

| | | |
|---------------|---|---|
| EcoPro | keys / settings: LEDs: inputs: | on/off, test, two viscosity modes, metering volume 1:100 operation, viscosity, alarm release |
| EcoEvo | keys / settings: LEDs: operation mode: inputs: outputs: | on/off, test, mode, two operating modes, two viscosity modes, metering volume 1:100 operating mode, operation, viscosity, alarm manual, pulse release, pulse, level stroke signal, alarm |
| EcoAdd | keys / settings: operation / display: operation mode: inputs: outputs: communication: option: | on/off, four viscosity modes, five operating modes, metering volume up to 1:12000 touch display manual, pulse, current, timer, charge release, pulse, current, charge, level, flow, diaphragm break stroke signal, alarm USB Bluetooth extension module |

| Pump type | | | 5 | 11 | 30 | 50 | 120 |
|----------------------------------|--------|-----|---------------------------|-----------|-----------|-----------|------------|
| metering capacity min. / max. | EcoPro | l/h | 0.05 - 5 | 0.11 - 11 | 0.3 - 30 | 0.5 - 50 | 1.2 - 120 |
| | EcoEvo | | | | | -- | -- |
| | EcoAdd | | 0.01 - 5 | 0.01 - 11 | 0.01 - 30 | 0.01 - 50 | 0.01 - 120 |
| max. metering back pressure | bar | | 10 | 10 | 3 | 10 | 3 |
| connection thread | | | 3/8" | 3/8" | 5/8" | 5/8" | 1 1/4" |
| reproductibility | | | +/- 3% | | | | |
| max. suction height | m | | 2 | | | | |
| max. metering frequency | 1/min | | 171 | 176 | 166 | 162 | 165 |
| ambient temperature | °C | | 2 - 45 | | | | |
| power supply | V | | 100 - 240 V +10% 50/60 Hz | | | | |
| safety type | | | IP 65 | | | | |
| certificates | | | CE, UL | | | | |

Variabel Structure

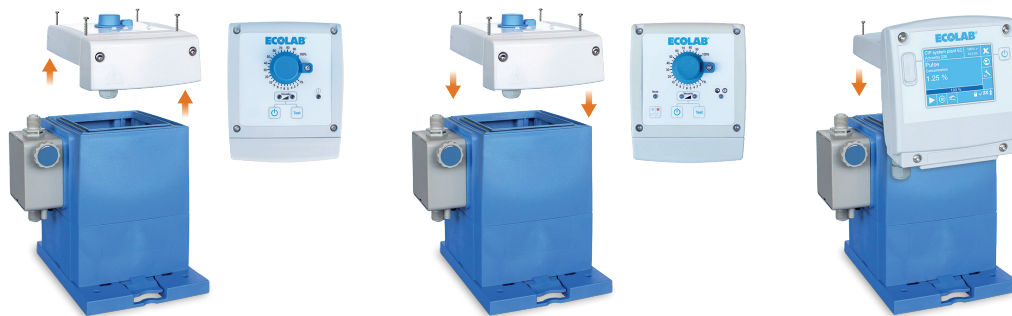

Conversion from **EcoPro** to **EcoEvo** or **EcoAdd**



Flexible installation

Ecolab Engineering GmbH

Postfach 1164 83309 Siegsdorf
Tel. +49 8662 61 0
engineering-mailbox@ecolab.com
www.ecolab-engineering.de

